

PROJECT SUMMARY

PROJECT APPROX. 1468 ACRES
 SINGLE FAMILY RES. UNITS
 COMBINED 1/2" & 3/4" DIMENSIONED
 288 TOTAL SF
 (SINGLE-FAMILY TOWNHOMES)
 PARCELS: 471 270 UNITS
 TOTAL RESIDENTIAL UNITS = 538
 GENERAL RESIDENTIAL: 604 AC.
 GENERAL COMMERCIAL: 0.83 AC.
 DISPERSED: 2.81 S.U. / ACRES
 OPEN SPACE: 17.23 AC.
 OPEN SPACE: 17.23 AC.
 OPEN SPACE: 17.23 AC.

- 21 COMMERCIAL
- 31 70 FOOT WIDE LOT
- 41 60 FOOT WIDE LOT
- 43 BUILDINGS
- 53 20 FOOT WIDE LOT
- 63 PARKS/OPEN SPACE
- 73 CONSERVATION/DRAINAGE
- U1 WATER

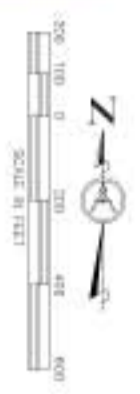

TYPICAL LOT

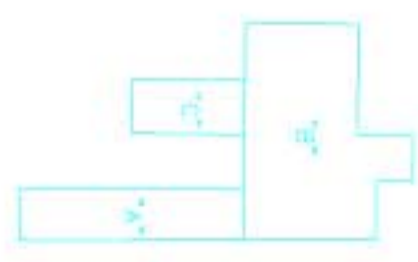
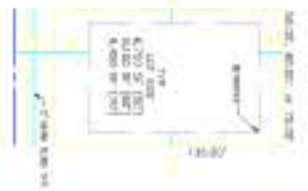

<p>DATE: 11/29/2008 TIME: 11:00 AM DRAWN BY: [Name] CHECKED BY: [Name] PROJECT NO: [Number]</p>	<p>CIVIL-TECH CONSULTING ENGINEERS, INC. CIVIL ENGINEERS & PLANNERS 12 South Main Street, Brooksville, FL 34601 Phone - (352) 796-6319 / Fax - (352) 799-8203 WWW.CIVIL-TECH.COM Registration # E25-000746</p>	<p>COVINGTON HILL HERNANDO COUNTY, FLORIDA MASTER PLAN</p>	<p>DATE: 11/29/2008 TIME: 11:00 AM DRAWN BY: [Name] CHECKED BY: [Name] PROJECT NO: [Number]</p>
---	--	---	---